

# ET4L Mac Build Guide

For 2018/2019 iMac, MacBook Air, MacBook Pro and Mac Mini

## Newly purchased mac

Use these steps to build a brand-new mac with the ET4L managed operating environment.

## Run through the Setup Assistant

Welcome

Select **Australia**, then click **Continue**.

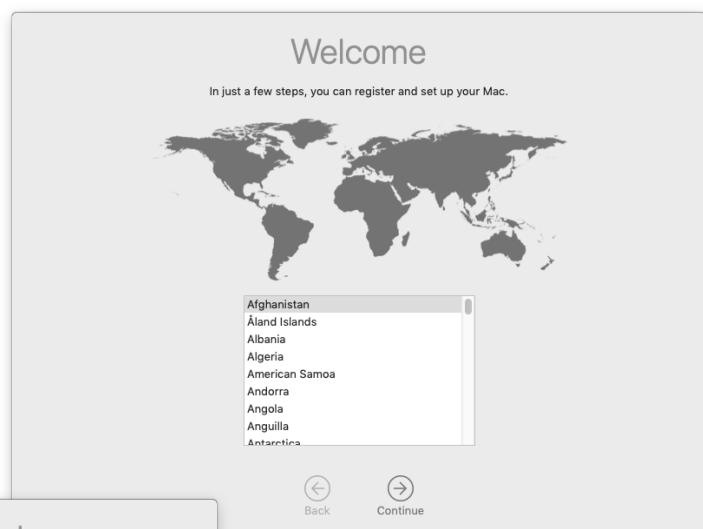

Select Your Keyboard

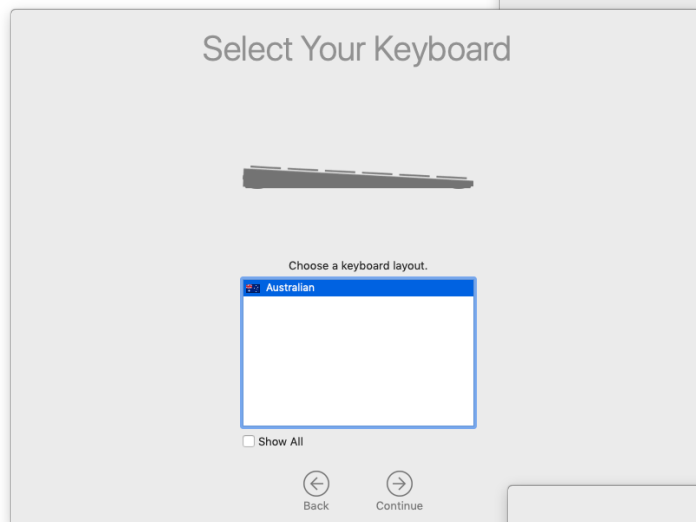

Make sure **Australian** is selected, then click **Continue**.

Data & Privacy

Click **Continue**

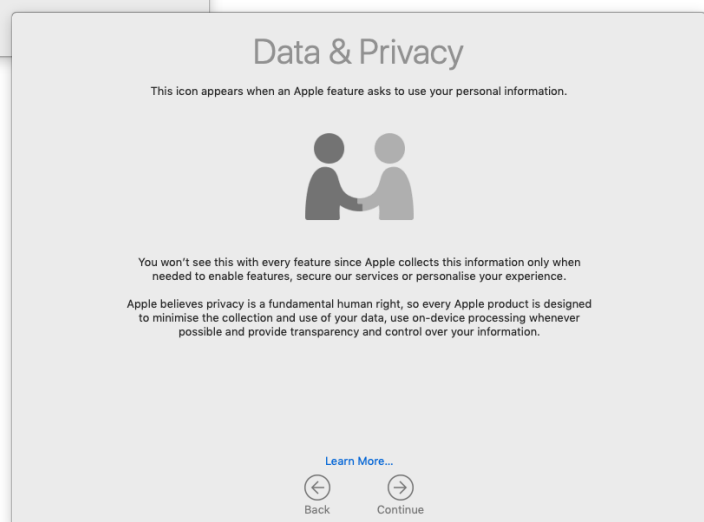

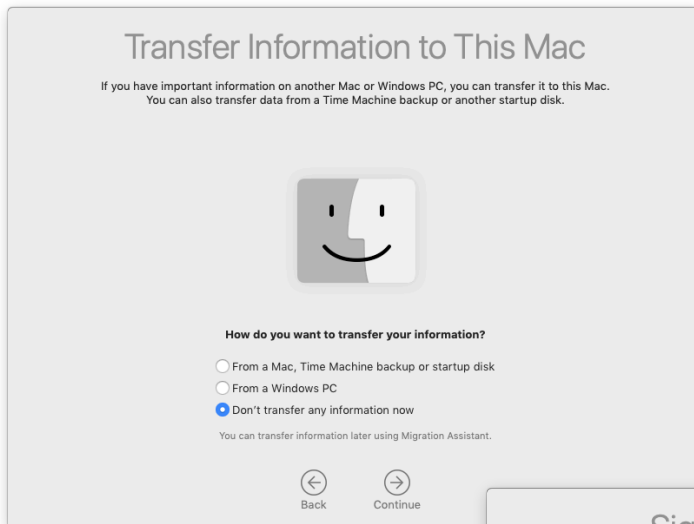

## Transfer Information to This Mac

Choose **Don't transfer any information now**. If you want to transfer applications and settings from an old mac, you can do this at any time later in the process by running **Migration Assistant**.

## Apple ID

Click the link to **Set Up Later**, you can sign in to an Apple ID after the mac has been set up.

A window will pop up asking you to confirm, choose **Skip**

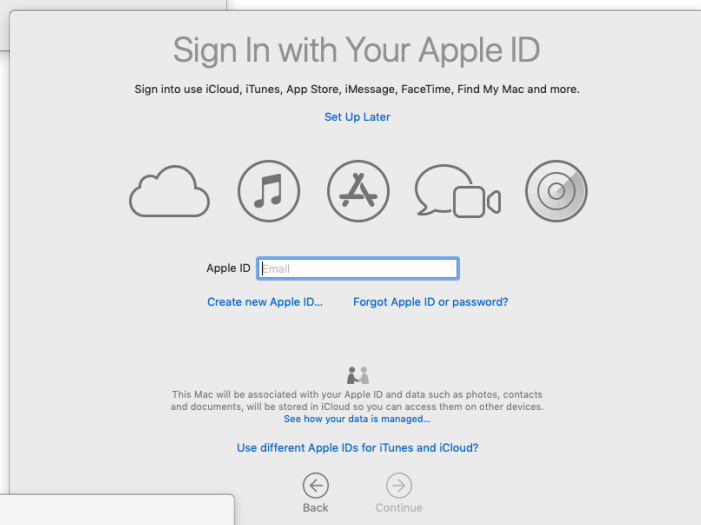

## Terms and Conditions

Agree to the terms.

A window will pop up confirming that you accept. Click **Agree**

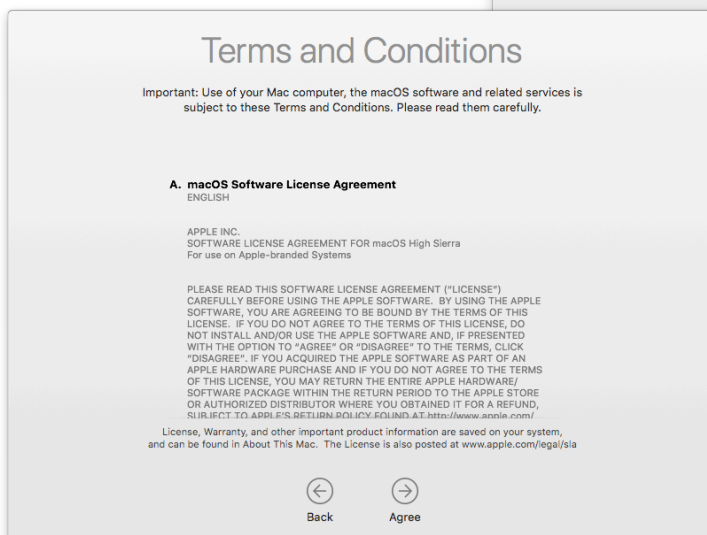

## Creating a User Account

In the next step, you create a temporary account to start the build process with.

### Create a Computer Account

Fill out the following information to create your computer account.

Full name:

Account name:   
This will be the name of your home folder.

Password:

Hint:

[← Back](#) [→ Continue](#)

Create a user called **setup** with a password of **setup**

This user will be automatically deleted at the end of the process (if the process finishes successfully).

**Continue**



Express Set Up

Click **Continue**

### Express Set Up

The features and settings below will be set up for you, or you can customize the settings yourself.

[Learn More](#)

-  Allow Maps and other apps and services like Find My Mac and Spotlight Suggestions to gather and use data to determine your location.
-  Help Apple improve its products and services by allowing analytics of usage and data from this Mac and allowing Apple to share crash data with developers to improve their apps.

[Customize Settings](#)

[← Back](#) [→ Continue](#)

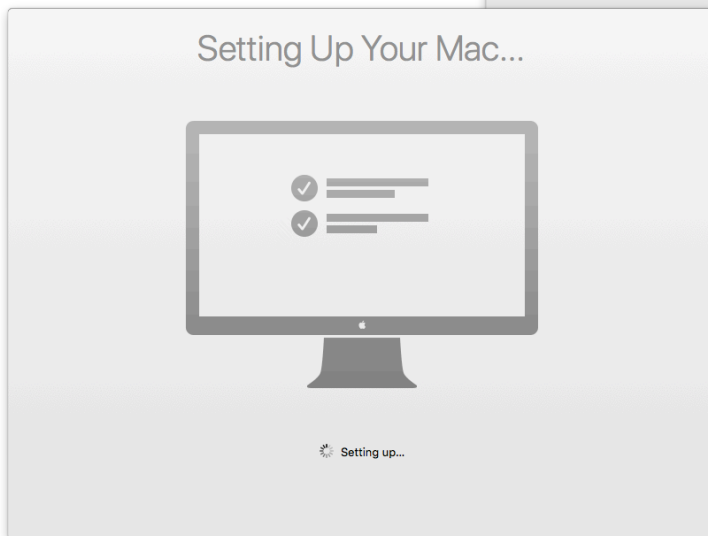

Setting Up Your Mac...

The Setup Assistant has finished.

You should now be logged in and see the desktop.

## Download the agent



Open **Safari** from the Dock

Type in the following URL to download the agent package:

<https://msc.det.nsw.edu.au/agent.pkg>

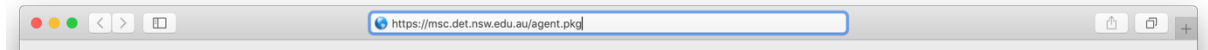

By default, the software will download to the *Downloads* folder. This is accessible from the right-hand side of the Dock as shown below.



## Run the agent and reboot

Click on the **agent.pkg** shown in the Downloads “stack”, which is located in the dock. The installer for Munki – Managed software installation for OS X should start. Click **Continue**

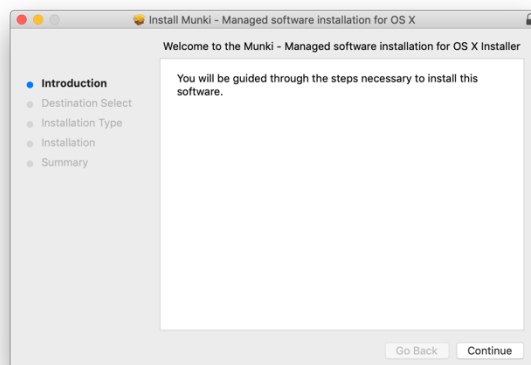

*NOTE: You should not receive the warning “This software is from an unidentified developer”. If you do receive this method, please log a call.*

You will be asked to enter the password for the temporary user you created in **Step 1**.

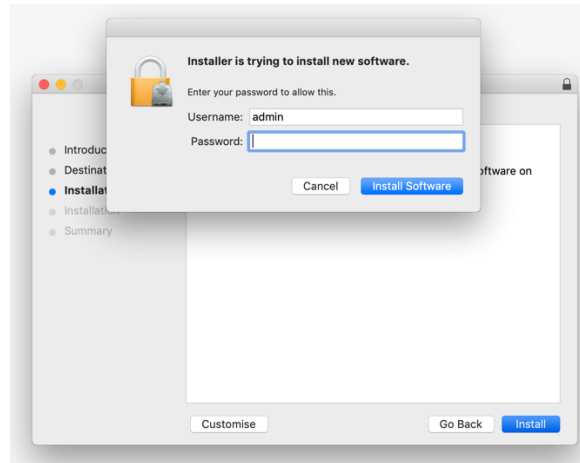

At the end of the process, you should see that the software installed successfully

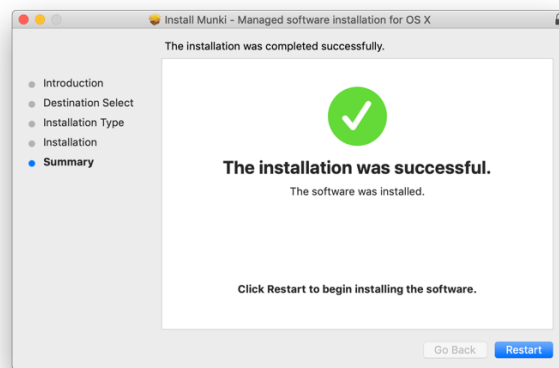

Restart and wait for software to install

The rest of this process is automated. Here's what to expect:

- The installer finishes, then asks to restart the Mac, click **Restart**.
- The Mac restarts and displays the login screen.
- A progress bar, titled "Managed Software Centre" is shown on top of the login screen, indicating that the ET4L software and settings are being installed.
- This will run approximately 4 times depending on software installed at that location.
- When the "Managed Software Centre" application no longer re-appears, you may log in to the mac.

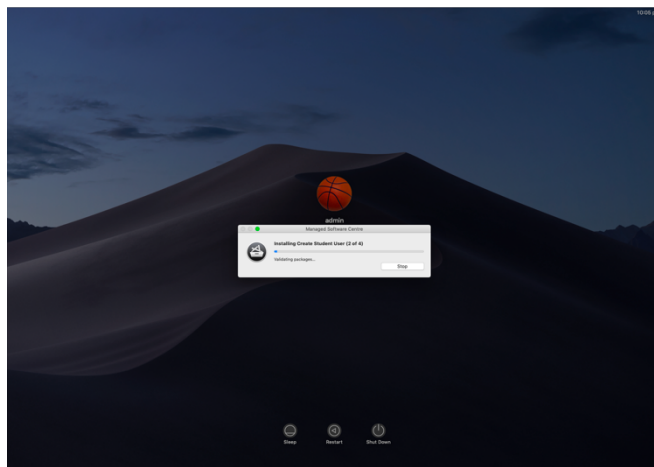
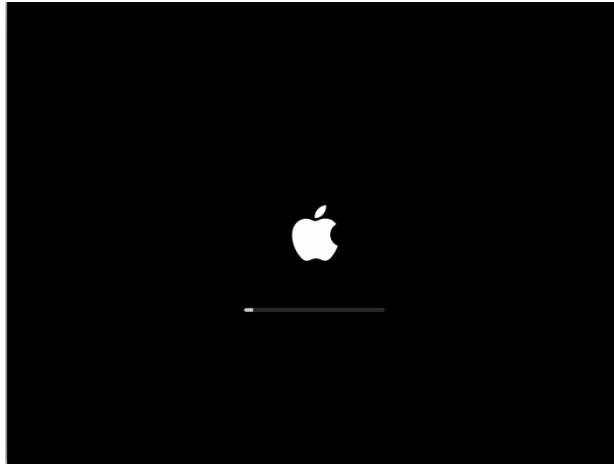

**The mac is now built to the ET4L standard**